



Small Signal Schottky Diode



Features

- Epoxy meets UL-94 V-0 flammability rating and halogen free
- Moisture Sensitivity Level 1
- Low Forward Voltage Schottky Rectifier
- V_{RRM} 30V
- I_{FAV} 200mA
- Part no. with suffix "Q" means AEC-Q101 qualified

Mechanical Data

- **Case:** SOT-323
- **Terminals:** Tin plated leads, solderable per J-STD-002 and JESD22-B102

SOT-323

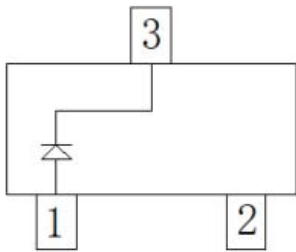

BAT54WTQ
Marking:KL5

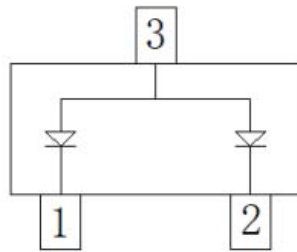

BAT54AWTQ
Marking:KL6

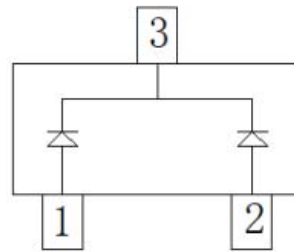

BAT54CWTQ
Marking:KL7

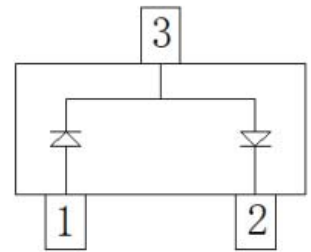

BAT54SWTQ
Marking:KL8

■ Maximum Ratings ($T_a=25^\circ\text{C}$ Unless otherwise specified)

| PARAMETER | SYMBOL | UNIT | CONDITIONS | VALUE |
|---|-----------------|--------------------|---------------------------------|-------------|
| Peak Repetitive Reverse Voltage | V_{RRM} | V | | 30 |
| Average Forward Current | $I_{FAV}^{[1]}$ | mA | | 200 |
| Non-Repetitive Peak Forward Surge Current | I_{FSM} | A | square wave $t_p < 10\text{ms}$ | 3 |
| Power Dissipation | $P_D^{[1]}$ | mW | | 200 |
| Thermal Resistance Junction to Ambient | R_{thJA} | $^\circ\text{C/W}$ | | 500 |
| Junction Temperature | T_j | $^\circ\text{C}$ | | -55 to +125 |
| Storage Temperature Range | T_{stg} | $^\circ\text{C}$ | | -55 to +150 |

[1] Single diode loaded



BAT54WTQ&BAT54AWTQ&BAT54CWTQ&BAT54SWTQ

■ Electrical Characteristics (T_a=25°C Unless otherwise specified)

| PARAMETER | SYMBOL | UNIT | CONDITIONS | MIN | MAX |
|---------------------------|-----------------|------|--|-----|------|
| Forward Voltage | V _F | V | I _F =0.1mA | | 0.24 |
| | | | I _F =1mA | | 0.32 |
| | | | I _F =10mA | | 0.4 |
| | | | I _F =30mA | | 0.5 |
| | | | I _F =100mA | | 1 |
| Reverse Current | I _R | μA | V _R =25V | | 2 |
| Reverse Breakdown Voltage | V _{BR} | V | I _R =10μA | 30 | |
| Junction Capacitance | C _J | pF | V _R =1V, f =1MHz | | 10 |
| Reverse Recovery Time | t _{rr} | ns | I _F =I _R =10mA, I _{rr} =1mA, R _L =100Ω | | 5 |

■ Ordering Information (Example)

| PREFERRED P/N | PACKING CODE | UNIT WEIGHT(g) | MINIMUM PACKAGE(pcs) | INNER BOX QUANTITY(pcs) | OUTER CARTON QUANTITY(pcs) | DELIVERY MODE |
|---|--------------|-------------------|----------------------|-------------------------|----------------------------|---------------|
| BAT54WTQ BAT54AWTQ BAT54CWTQ BAT54SWTQ | F2 | Approximate 0.006 | 3000 | 30000 | 120000 | 7" reel |



■ Characteristics (Typical)

Fig.1: P_D-T_A

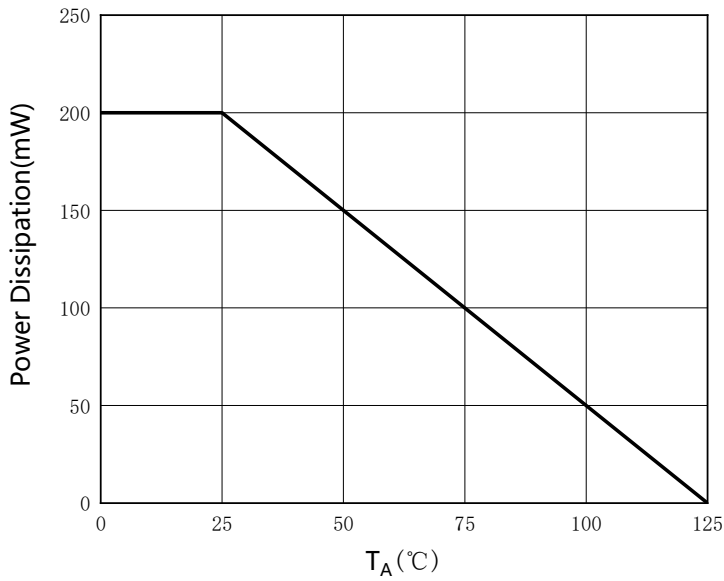

Fig.2: Capacitance Characteristics

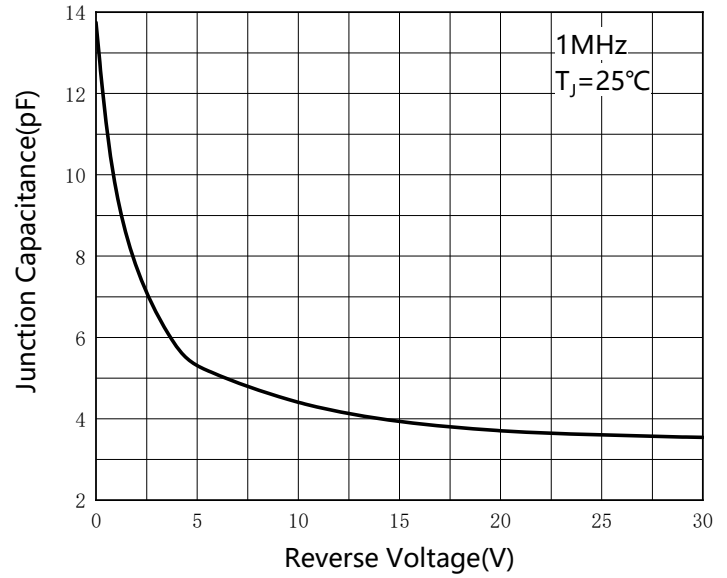

Fig.3: Forward Characteristics

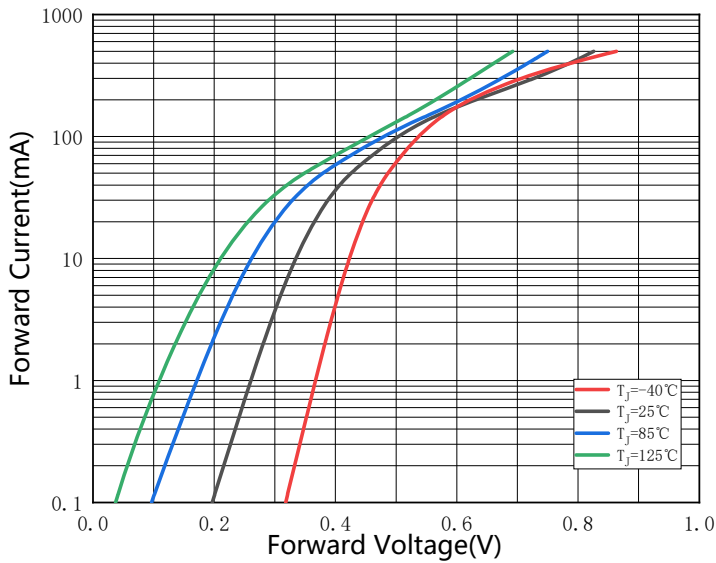
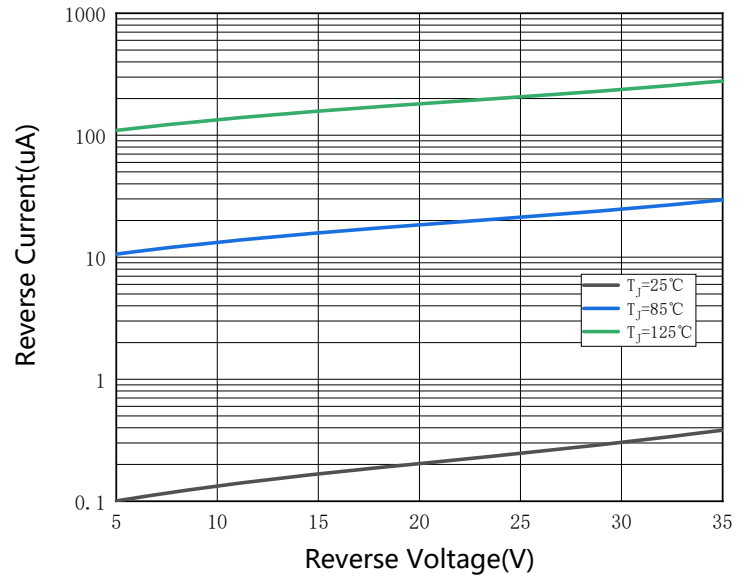
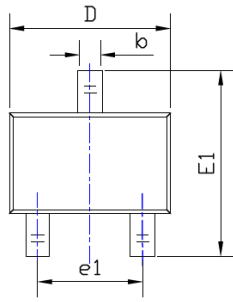

Fig.4: Reverse Characteristics





■ Outline Dimensions



TOP VIEW

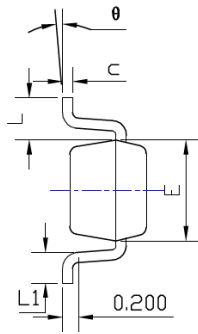

SIDE VIEW

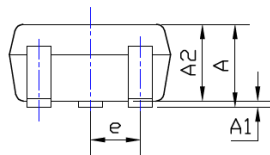

SIDE VIEW

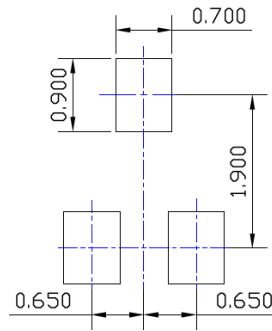

UNIT: mm

SUGGESTED SOLDER PAD LAYOUT

| SYMBOL | DIMENSIONS | | | |
|--------|------------|-------|------------|-------|
| | INCHES | | Millimeter | |
| | MIN. | MAX. | MIN. | MAX. |
| A | 0.035 | 0.043 | 0.900 | 1.100 |
| A1 | 0.000 | 0.004 | 0.000 | 0.100 |
| A2 | 0.035 | 0.039 | 0.900 | 1.000 |
| b | 0.006 | 0.016 | 0.150 | 0.400 |
| c | 0.004 | 0.010 | 0.100 | 0.250 |
| D | 0.071 | 0.087 | 1.800 | 2.200 |
| E | 0.045 | 0.053 | 1.150 | 1.350 |
| E1 | 0.085 | 0.096 | 2.150 | 2.450 |
| e | 0.026TYP | | 0.650TYP | |
| e1 | 0.047 | 0.055 | 1.200 | 1.400 |
| L | 0.021REF | | 0.525REF | |
| L1 | 0.010 | 0.018 | 0.260 | 0.460 |
| θ | 0° | 8° | 0° | 8° |

NOTE:

1.PACKAGE BODY SIZES EXCLUDE MOLD FLASH AND GATE BURRS.

2.TOLERANCE 0.1mm UNLESS OTHERWISE SPECIFIED.

3.THE PAD LAYOUT IS FOR REFERENCE PURPOSES ONLY.

■ Marking Information

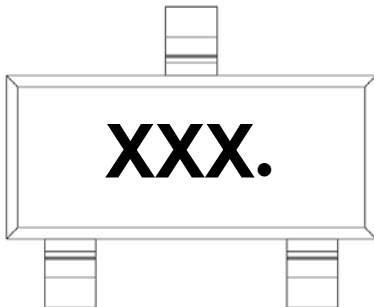

| PN | Marking Code |
|-----------|--------------|
| BAT54WTQ | KL5. |
| BAT54AWTQ | KL6. |
| BAT54CWTQ | KL7. |
| BAT54SWTQ | KL8. |

Note:

1. All marking is at middle of the product body
2. All marking is in laser marking
3. XXX is Marking Code
4. Body color: Black



Disclaimer

The information presented in this document is for reference only. Yangzhou Yangjie Electronic Technology Co., Ltd. reserves the right to make changes without notice for the specification of the products displayed herein to improve reliability, function or design or otherwise.

The product listed herein is designed to be used with automotive electronics, are not designed for use in medical, life-saving, lifesustaining, or military, Yangjie or anyone on its behalf, assumes no responsibility or liability for any damages resulting from such improper use of sale.

This publication supersedes & replaces all information previously supplied. For additional information, please visit our website [http:// www.21yangjie.com](http://www.21yangjie.com) , or consult your nearest Yangjie's sales office for further assistance.